

# SMALL VIBRATION TEST SYSTEMS



Photo : Model PET05-05A

<Table mounting bolt layout>

(Unit : mm)

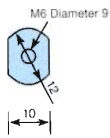

PET-01

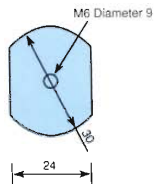

PET-05

( Specified  
when the  
order receipt )

VE-7144

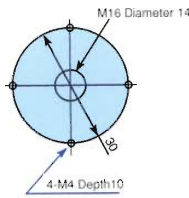

MS-VE-01N



Photo : Model CE-7144

## Specification

Name of the products		Vibro Pet			Vibraton Calibrator	
System Model		PET-01-0A	PET-05-05A	MS-VS-10	CE-7144 ※3	
System Performance	Frequency range Hz	2~12 000	2~14 000	5~5 000	2~20 000	
	Rated SINE Force N	9.8	49	98	49	
	Max. Acceleration m/s <sup>2</sup>	490 ※1	326 ※1	196 ※1	49 ※1	
	Max. Velocity m/s	—	—	0.54	—	
	Max. Displacement mmp-p	5	5	3	2	
	System power consumption	0.08 ※2	0.1 ※2	0.8 ※2	0.1 ※2	
Model		PET-01	PET-05	MS-VE-01N	VE-7144	
Vibrator	Armature Guidance System	Diaphragm Spring	Diaphragm Spring	Diaphragm Spring/Rollers	Rocker Flexure s/ Rollers	
	Loading support stiffness kN/m	9.8	15.6	49	3.9	
	Mass of armature kg	0.02 ※1	0.15 ※1	0.5 ※1	1 ※1	
	Diameter of vibration table mm	12	30	40	82	
	Dimensions WxHxD mm	φ75xH97	φ116xH115	330x235x190	φ148xH200	
	Weight kg	1.5	4.5	14.5	14.2	
Model		PET-0A	PET-05A	VA-ST-03	CE-7144	
Power Amplifier	Max. Output kVA	0.03	0.045	0.3	0.05	
	Dimensions WxHxD mm	300x140x280	300x140x280	430x200x500	300x140x280	
	Weight kg	9	9	30	9.3	
Cooling	Type of cooling	Natural air cooling	Natural air cooling	Forced air cooled	Natural air cooling	
	Cooling blower	Dimensions WxHxD mm	—	—	159x173x149	—
		Weight kg	—	—	2.5	—
System Model		PET-01-0AM	PET-05-05AM			
Vibration meter unit	Dimension of power amplifier WxHxD mm	300x140x280	300x140x280			
	Dimension of power amplifier	9.3	9.3			
	Frequency range	5Hz - 5,000Hz (Model VP-32 accelerometer is used)				
	Acceleration measurement	3 range / 10, 100, 1000 m/s <sup>2</sup> 1.0~11.0pc (m/s <sup>2</sup> )				
	Accelerometer sensitivity	1.0 ~ 11.0 pc/ (m/s <sup>2</sup> ) <sup>2</sup>				

- ※1) The above are specifications under no loading condition. The maximum acceleration decreases when accelerometer and mounting adapter are mounted.  
 ※2) Power supply voltage 1 phase 100V AC 50/60Hz ±10%. Voltage Down Transformer (Step-down transformer) is required for other voltage.  
 ※3) Except Model CE-7144 system, IMV prepares many calibration systems such as for seismic sensors, vibration monitoring system sensors, or highly accurate sensor calibration systems. Contact the sales representative or IMV if you need further information.

# SMALL VIBRATION TEST SYSTEMS

## (LARGE TABLE TYPE)

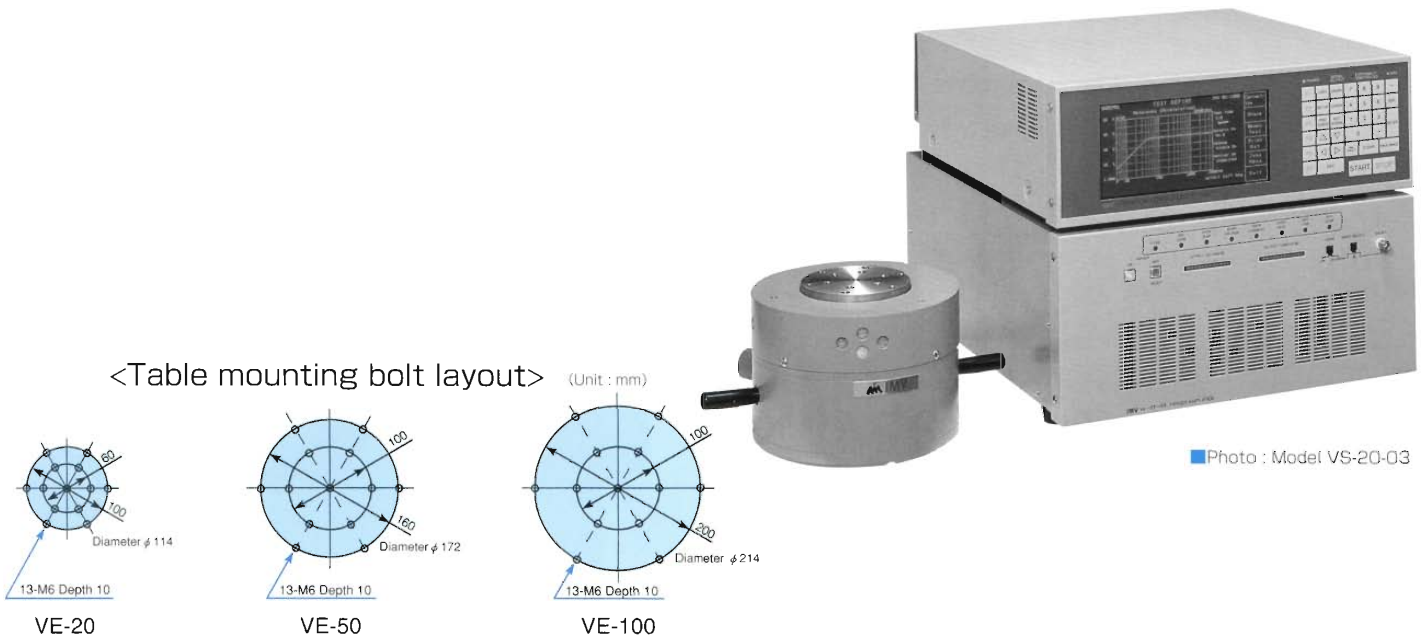

### Specification

Name of the products		Large table type Small Vibration Test Systems			
System Model		VS-20-03	VS-30-03	VS-50-06	VS-100-1
System Performance	Frequency range Hz	5~3 000	5~3 000	5~3 000	5~2 000
	Rated SINE Force N	196	294	490	980
	Max Acceleration m/s <sup>2</sup>	490 ※1	264 ※1	441 ※1	490
	Max. Velocity m/s	1.2	0.7	1.2	1.2
	Max. Displacement mmp-p	8	10	10	15
	System power consumption	0.8 ※2	0.8 ※2	1.5 ※2	3.2 ※3
Vibrator	Model	VE-20	VE-50	VE-50	VE-100
	Armature guidance system	Leaf spring / Rollers			Rocker flexure s/ Rollers
	Loading support stiffness kN/m	39.2	39.2	39.2	39.2
	Mass of armature kg	0.4 ※1	1.11 ※1	1.11 ※1	2.0
	Diameter of vibration table mm	114	172	172	214
	Dimensions WxHxD mm	$\phi$ 214xH162	$\phi$ 266xH195	$\phi$ 266xH195	$\phi$ 330xH243
	Weight kg	21	45	45	90
Power Amplifier	Model	VA-ST-03	VA-ST-03	VA-ST-06	VA-1
	Max. Output kVA	0.3	0.3	0.6	1
	Dimensions WxHxD mm	430x200x500	430x200x500	430x200x500	550x1,700x800
	Weight kg	30	30	35	230 ※4
Cooling chiller	Type of cooling	Force air cooling	Force air cooling	Force air cooling	Force air cooling
	Dimensions WxHxD mm	200x217x207	200x217x207	200x217x207	294x302x298
	Weight kg	7.5	7.5	7.5	19

※1) The above are specifications under no loading condition. The maximum acceleration decreases when accelerometer and mounting adapter are mounted.

※2) Power supply voltage 1 phase 100V AC 50/60Hz  $\pm$ 10%  
Voltage Down Transformer (Step-down transformer) is required for other voltage.

※3) Power supply voltage 3 phase 200V AC 50/60Hz  $\pm$ 10%  
Voltage Down Transformer (Step-down transformer) is required for other voltage.

※4) With the power amplifier console rack to install using vibration controller

★Vibration isolation rubber pad is included in Model VS-20-03, VS-30-03 and VS-50-06 as a standard accessory.

# SMALL VIBRATION TEST SYSTEMS

## (WIDE BAND FREQUENCY TYPE)

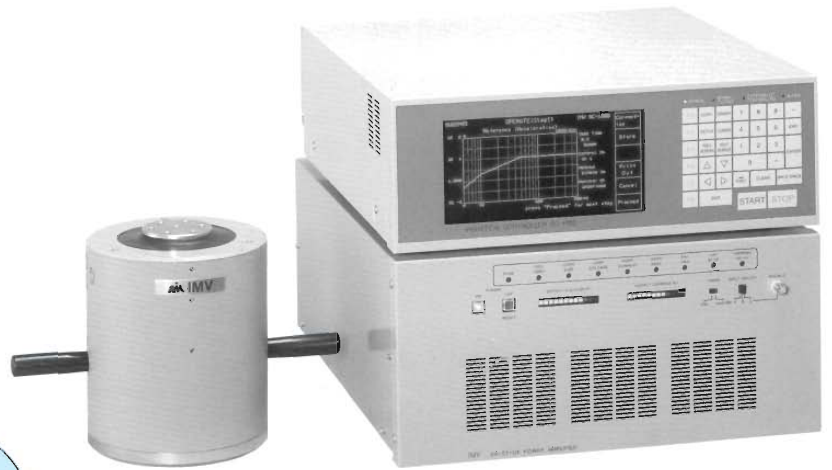
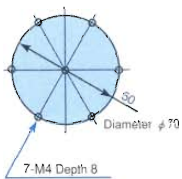
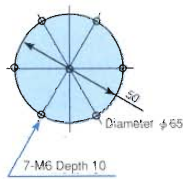

Photo : Model VSH-10-03

<Table mounting bolt layout> (Unit : mm)



VEH-10

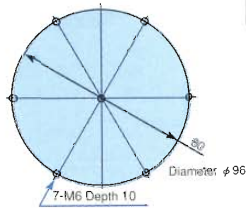

VEH-50

VEH-100  
VEH-100R

### Specification

Name of the products		Wide Band Frequency Vibration Test Systems				
System Model		VSH-10-03	VSH-30-06	VSH-50-1	VSH-100-1	VSH-100R-1 ※4
System Performance	Frequency range Hz	5~12 000	5~10 000	5~10 000	5~8 000	5~10 000
	Rated SINE Force N	98	294	490	980	980
	Max Acceleration m/s <sup>2</sup>	245 ※1	392 ※1	653 ※1	980 ※1	980 ※1
	Max. Velocity m/s	—	—	1.2	0.8	0.8
	Max. Displacement mmp-p	5	8	8	10	10
	System power consumption	0.5 ※2	1.5 ※2	2.3 ※3	3.5 ※3	3.5 ※3
Vibrator	Model	VEH-10	VEH-50	VEH-50	VEH-100	VEH-100R
	Armature guidance system	Flexures/ Rollers	Diaphragm Spring		Rollers / Air suspension	Flexure s/ Rollers
	Loading support stiffness kN/m	12.2	29.4	29.4	Max. Loading 30kg	49
	Mass of armature kg	0.4 ※1	0.75 ※1	0.75 ※1	1.0 ※1	1.0 ※1
	Diameter of vibration table mm	70	65	65	96	96
	Dimensions WxHxD mm	φ180×214	φ310×322	φ310×322	φ390×306	φ390×306
	Weight kg	26	70	70	120	120
Power Amplifier	Model	VA-ST-03	VA-ST-06	VAG-1	VAH-1	VAH-1
	Max. Output kVA	0.3	0.6	1	1	1
	Dimensions WxHxD mm	430×200×500	430×200×500	550×1700×800	550×1700×800	550×1700×800
	Weight kg	30	35	230 ※4	230 ※4	230 ※4
Cooling	Type of cooling	Forced air cooled	Forced air cooled	Forced air cooled	Forced air cooled	Forced air cooled
	Dimensions WxHxD mm	188×198×204	229×234×247	229×234×247	247×252×284	247×252×284
	Weight kg	5.5	8.5	8.5	10.5	10.5

※1) The above are specifications under no loading condition. The maximum acceleration decreases when accelerometer and mounting adapter are mounted.

※2) Power supply voltage 1 phase 100V AC 50/60Hz ±10%  
Voltage Down Transformer (Step-down transformer) is required for other voltage.

※3) Power supply voltage 3 phase 200V AC 50/60Hz ±10%  
Voltage Down Transformer (Step-down transformer) is required for other voltage.

※4) With the power amplifier console rack to install using vibration controller

★Vibration isolation rubber pad is included as a standard accessory.